

SIGNATONE

SCA-50 Coaxial High-Frequency or Low-Level Signal Probe

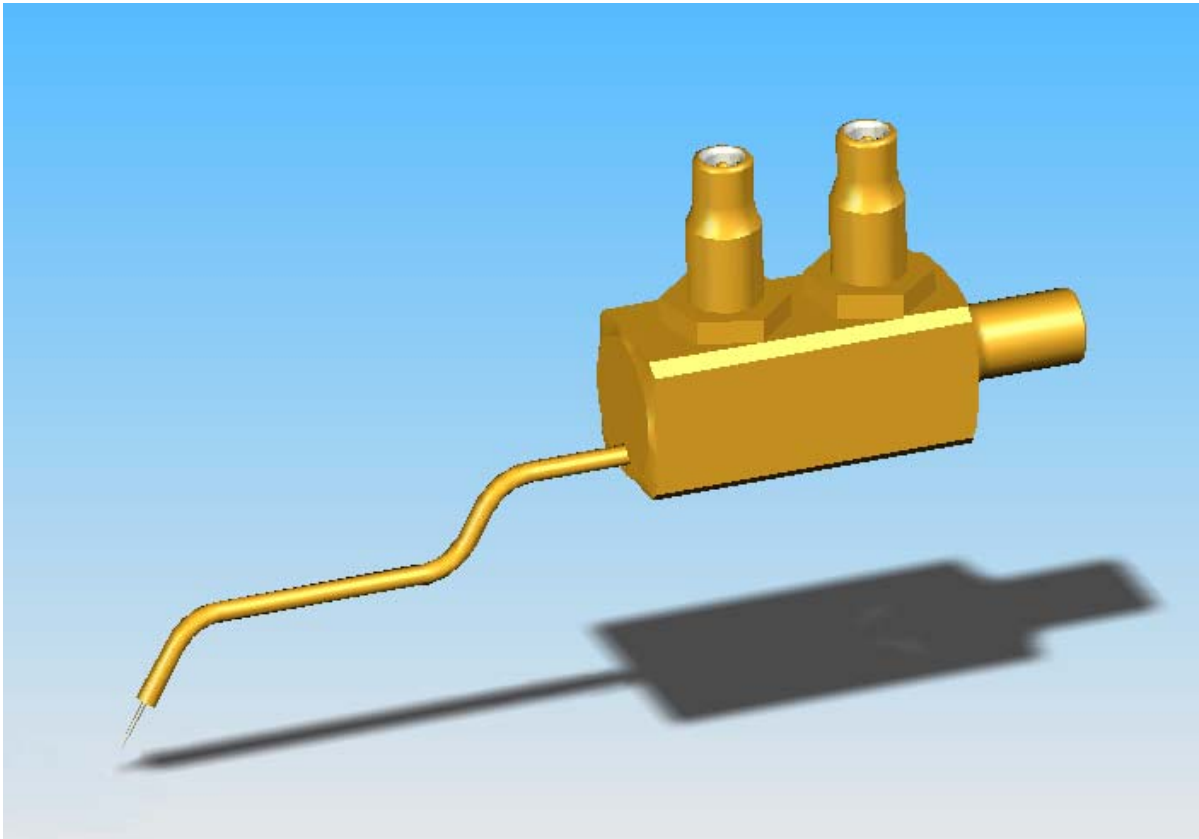

Coaxial Probes are designed for low-level signal probing to *less than 10fA*. The probe's single unit design is especially desirable for the best possible electrical characteristics, yet still offers the convenience of replaceable coax tips. The Coaxial Probe is also offered in optional ground plane and resistor terminated configurations. Several tip sizes are available from $.5\mu$ to 12.5μ . Special tapers and custom bend profiles are also available. Please contact the factory with your unique application requirements. 1 & 2 meter SSMC to BNC cables available separately.

CONSTRUCTION

The Probes are constructed of microwave-quality components. The 50 Ohm semi-rigid cable consists of 8 mil tungsten wire forming the inner conductor and probe point, isolated from the gold plated copper shield with a Teflon dielectric. The probe contact protrudes from the shielding by $.150''$ to maintain low-level signal noise to the probe. The probes use industry standard SSMC connectors mounted into the probe body.

SPECIFICATIONS:

Tip Radius: $.5\mu$, $.75\mu$, 1.0μ , 1.5μ , 5μ , 7μ , 10μ , 12.5μ **Note:** Tips sold separately in boxes of 10
Leakage: $<10fA$ @ $200^{\circ}C$
Frequency: DC to 500MHz
Mounting: $.125''$ stud

SIGNATONE

SCA-250 True-Kelvin Coaxial Probes

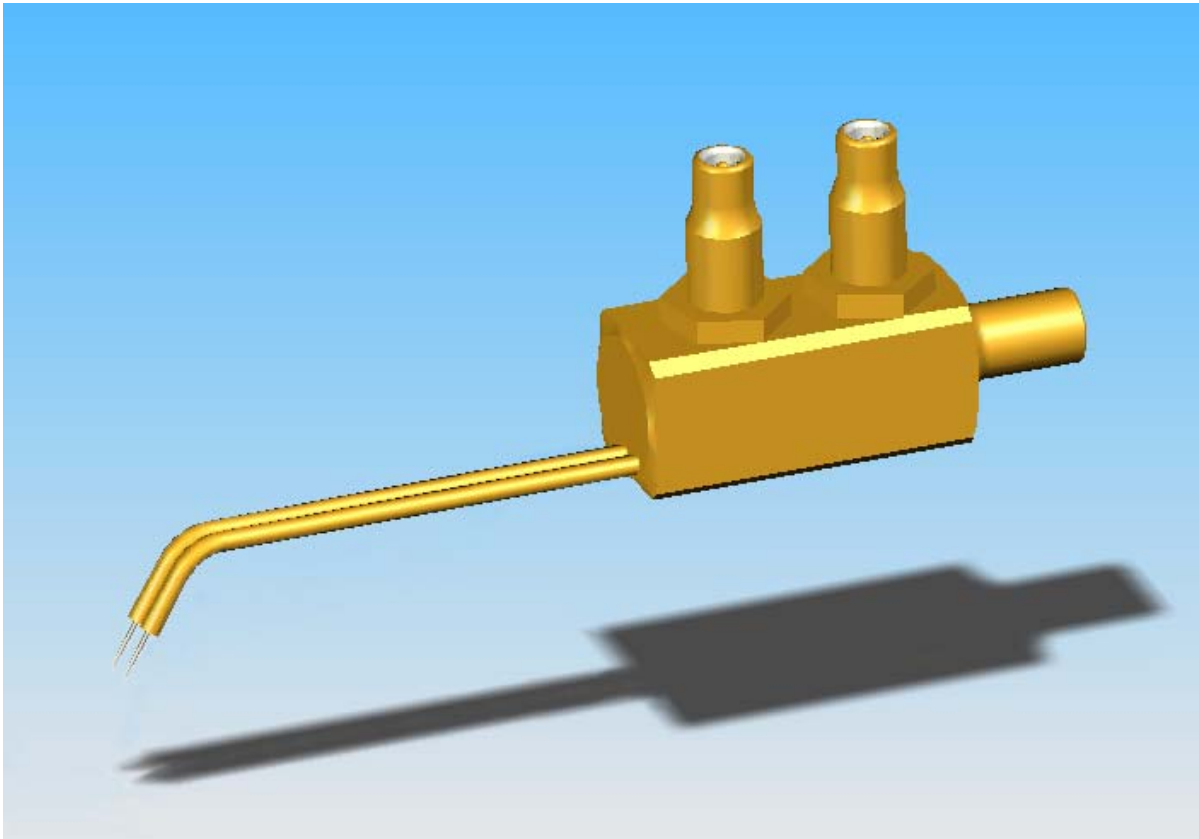

Kelvin Probes are designed for low-level resolution measurements in high-current applications. The probe's single unit design is especially desirable for the best possible electrical characteristics, and improves tip control over conventional dual tip designs. These probes are much more convenient in applications requiring multiple contacts on a single pad, such as with LCR meter measurements. The Kelvin Probe is offered in several tip sizes from $.5\mu$ to 12.5μ , with tip spacing in the range of 12.5μ to 100μ . Special tapers and custom bend profiles are also available. Please contact the factory with your unique application requirements. 1 & 2 meter SSMC to BNC cables available separately.

CONSTRUCTION

The Probes are constructed of microwave-quality components. The 50 Ohm semi-rigid cable consists of 8 mil tungsten wire forming the inner conductor and probe point, isolated from the gold plated copper shield with a Teflon dielectric. The probe contact protrudes from the shielding by $.150''$ to maintain low-level signal noise to the probe. The two coax probes are soldered together prior to plating to improve tip spacing and rigidity. Like the SCA-50 the probes use industry standard SSMC connectors mounted into the probe body.

SPECIFICATIONS:

Tip Radius: 5μ , 10μ , 12.5μ

Tip Spacing: 12.5μ , 25μ , 35μ , 75μ , 100μ ,

Leakage: $<10fA$ @ $200^{\circ}C$

Mounting: $.125''$ stud

Note: Kelvin tips are non-replaceable